

PROJECT _____ DATE _____ TYPE _____
 NOTES _____



HEAVY-DUTY, IP-66 RATED HOUSING

The 1016 is constructed with Die Cast Aluminum End-Caps and Individually sealed LED Modules to create a Heavy-Duty Housing

FLEXIBLE LIGHT OUTPUT CONFIGURATIONS

Extensive offering of Wattage, Optics and CCT options allow the 1016 to meet a wide-range of project requirements

EASY TO INSTALL MOUNTING HARDWARE

The 1016 comes standard with an Integral Slip Fitter engineered to be installed on a 2.375" Diameter Pole

120-277V STANDARD

PRODUCT APPLICATIONS

- Parking Lots
- Walkways
- Street scapes
- Plazas
- Playgrounds
- Parks & Recreational Fields

ORDERING GUIDE

MODEL	WATTAGE	COLOR TEMPERATURE (CCT)	OPTICS	HOUSING COLOR	OPTIONS & ACCESSORIES
SP1016-					
	60W	30K 3000K - WARM WHITE	T1 TYPE I	BZ BRONZE (STANDARD)	PC1 120V PHOTOCELL
	100W	40K 4000K - NEUTRAL WHITE	T2 TYPE II	WH WHITE	PC2 208/277V PHOTOCELL
	120W	50K 5000K - COOL WHITE	T3 TYPE III	BL BLACK	MS MOTION SENSOR
	150W	57K 5700K - DAYLIGHT	T4 TYPE IV	SL SILVER	D1 0-10V DIMMING
	200W		20D TYPE V - 20° BEAM ANGLE	DG DARK GREY	D2 STEP DIMMING
	250W		40D TYPE V - 40° BEAM ANGLE	CC CUSTOM COLOR	NC1 NETWORK CONTROLS FOR ZIGBEE
	300W		80D TYPE V - 80° BEAM ANGLE		HS HOUSE-SIDE SHIELD
			170D TYPE V - 170° BEAM ANGLE		WG PROTECTIVE WIRE GUARD
					V1* 480/347V INPUT (120-277V STANDARD)
					*NOT AVAILABLE WITH A PHOTOCELL OR MOTION SENSOR

PRODUCT SPECIFICATIONS

SYSTEM WATTS	DELIVERED LUMENS	EFFICACY	MODULES	EPA	X: WIDTH
60W	7,800 LM	130 LM/W	2	1.884	10.7"
100W	13,000 LM	130 LM/W	3	2.292	13.5"
120W	15,600 LM	130 LM/W	4	2.712	16.3"
150W	19,500 LM	130 LM/W	5	3.12	19.1"
200W	26,000 LM	130 LM/W	6	3.528	21.9"
250W	32,500 LM	130 LM/W	7	3.948	24.7"
300W	39,000 LM	130 LM/W	8	4.356	27.5"

PRODUCT DIMENSIONS

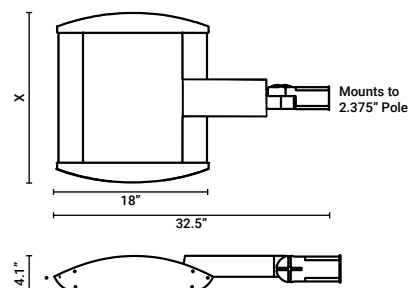

* Output lumens based on 5000K w/170D optics